



FATBAGBIKE



FATBAGRACK

Instruction for assembly and use



FBR01-1PR 2025

YOUR JOURNEY STARTS HERE

Congratulations on your new Fatbagbike.

This manual contains important information on the assembly, use and maintenance of the Fatbagbike's rack; FATBAGRACK. Please, read this manual carefully before using the Fatbagbike to ensure the safety use.

Information and instructions related to assembling and using the Yamaha Booster Easy -bicycle is provided in the bicycle's own user manual supplied with the bike.

Have sunny rounds of golf. [Let's Golf'n'Roll!](#)

Content

Introduction and safety information.....	3
Assembly instruction.....	5
- Adapter.....	6
- FATBAGRACK.....	7
Use of FATBAGRACK.....	8
Storage, maintenance and recycling.....	10

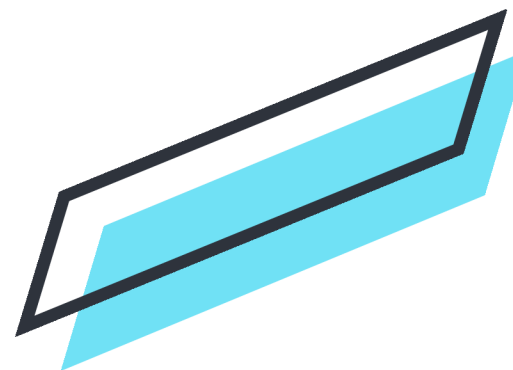

Introduction

Fatbagbike is intended to be used as a vehicle on the golf course. Fatbagrack is designed for carrying a golf bag only.

Fatbagbike is constantly seeking new solutions to improve the product and therefore it reserves the right to make changes to the supplied product in terms of shape and properties. Pictures and technical data in the manual can differ from the current product due to further development of the product. Fatbagbike reserves the right to change or cancel the data contained in this document without prior notice. The reproduction or translation of any part of this manual is forbidden without the consent of Fatbagbike.

This manual provides instructions for assembling and using of Fatbagrack. Incorrect assembly or use may cause damage. To be able to use the rack safely, read the manual in its entirety before using the product. Keep the user manual for future reference. Please read information and instructions for using of the Yamaha Easy Booster –bicycle in its own user manual supplied with the bike.

Fatbagbike is supplied in pre-assembled modules, which must be assembled into the finished product. Check the contents of every package for any shipping damages.

Copyright © 2024 Fatbagbike. All rights reserved.
Pat.pend. 466221WO-H



Safety information

The Fatbagrack is only allowed to be used on Yamaha Booster Easy models. Fatbagbike collaborates with Yamaha Finland, and we recommend following the safety instructions provided by the bicycle manufacturer when riding or using the bicycle.

Fatbagrack is intended for carrying a golf bag only. Fatbagrack is not suitable for a child seat.

Do not modify or rebuild the Fatbagrack and/or Fatbagbike. Avoid strong impacts to the rack.

WARNING: The bicycle behaves differently when the Fatbagrack is fitted on the bicycle. When the Fatbagrack is loaded, be aware that ride might be more unstable and will affect steering and braking in particular. Always distribute the weight as evenly as possible on the rack. Test ride the bicycle in a safe location before actual use.

WARNING: Ensure that golf bag fitted to Fatbagrack is securely attached with the straps provided. Check that there are no loose straps or pieces of bag that can get caught in the wheel while driving. If you are using Fatbagrack without a load, make sure the straps are not hanging loose.

NOTE! Lamps and reflectors should be mounted in the designated location. Check that the lamp and/or the reflex is approved in the country you are riding the bicycle in. Also make sure that an object does not obscure the lights and/or reflectors.

NOTE! Check all fasteners and tighten them regularly.

NOTE! Always check Fatbagrack for damage after a fall

WARNING: Do not leave packaging parts (plastic bags, polystyrene, straps, etc.) within the reach of children.



Assembly instruction

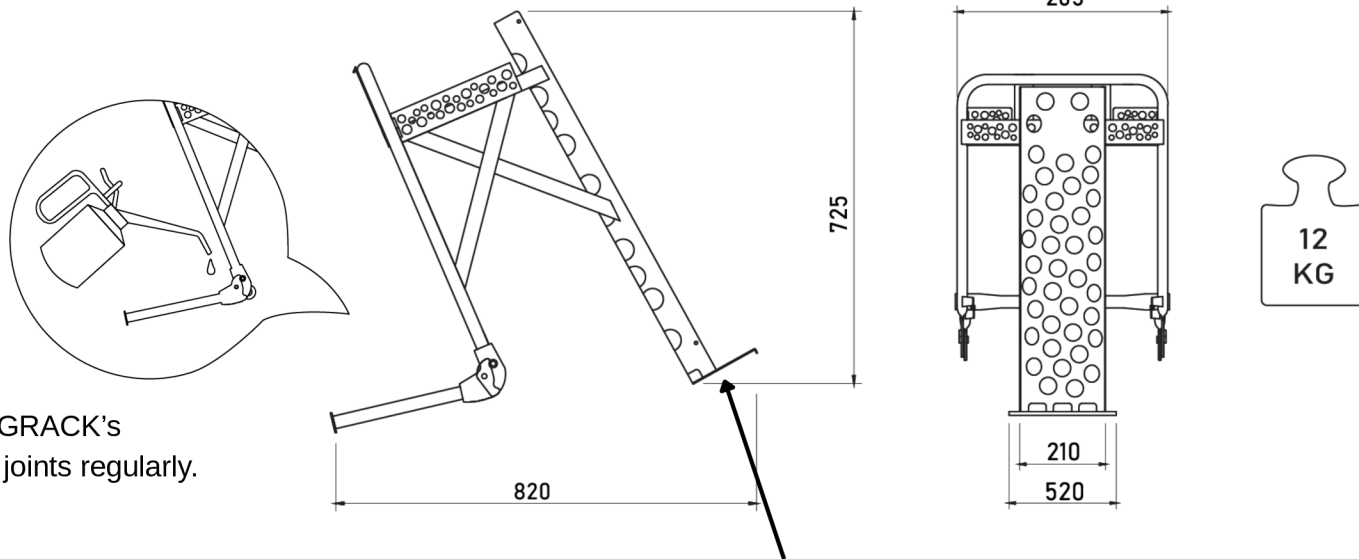

Assembly supplies

Made in Finland



Manufacturing and import:
Fatbagbike Ltd Pat.Pend. 466221WO-H

Weight:
12KG

Series:
0025

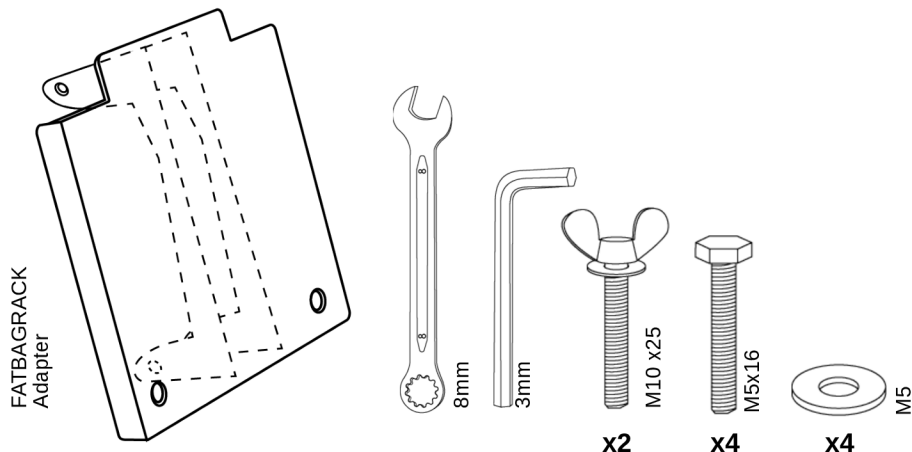

Assembly instruction

ADAPTER

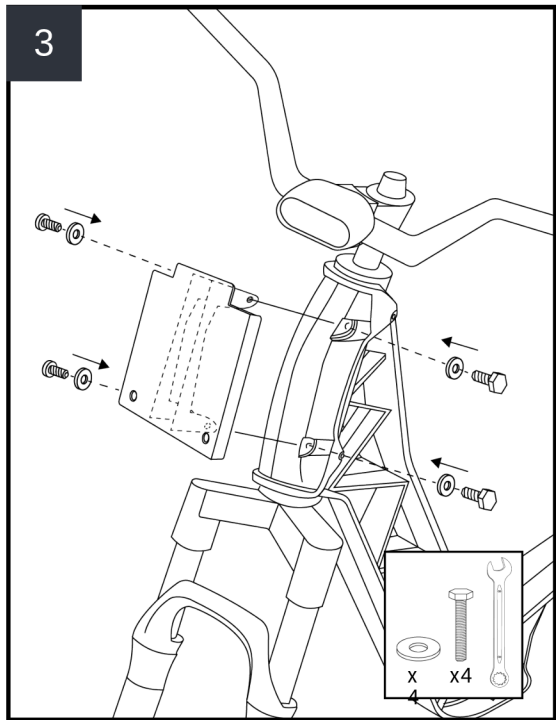
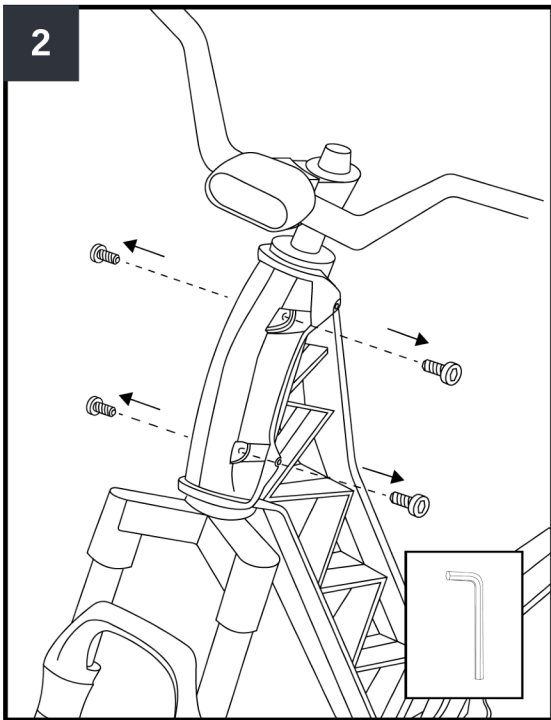
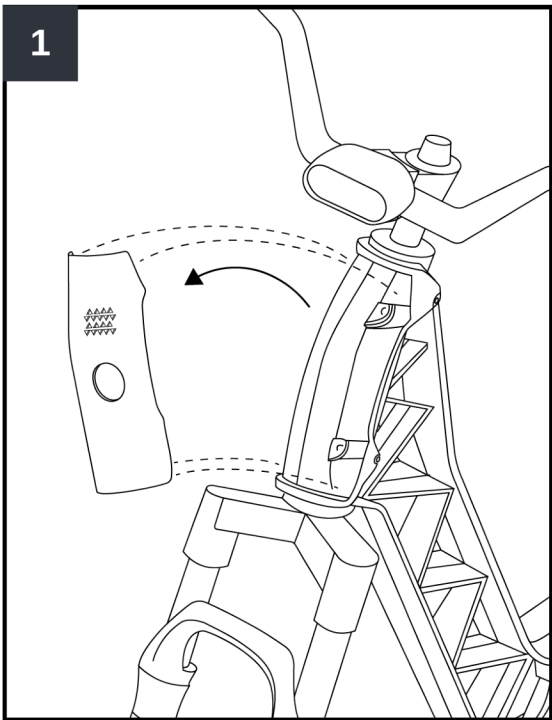
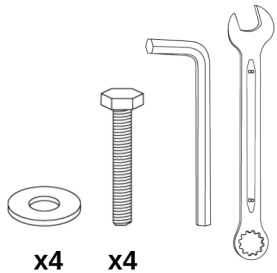

Assembly instruction

FATBAGRACK

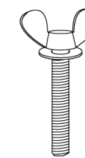

x2

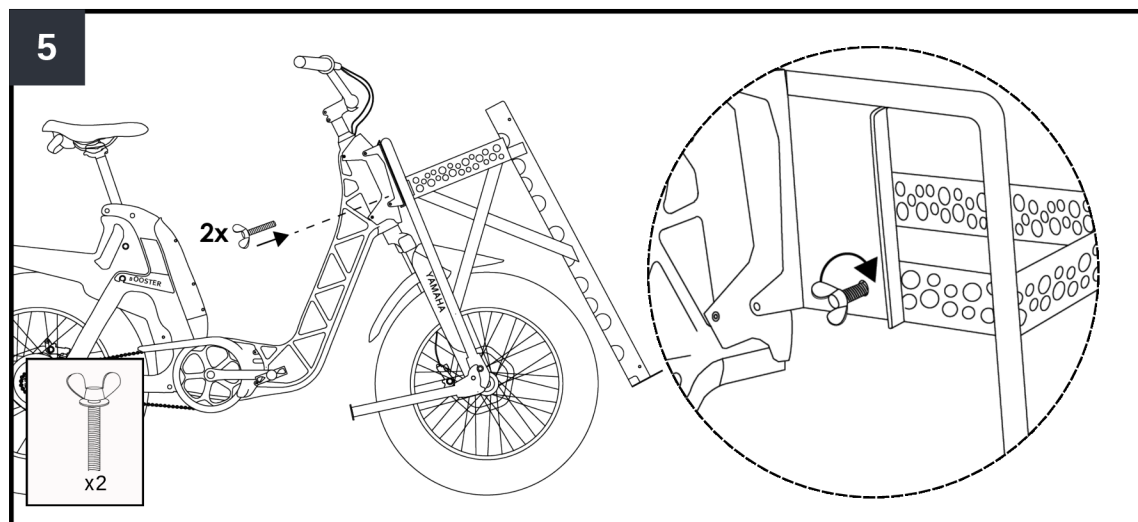
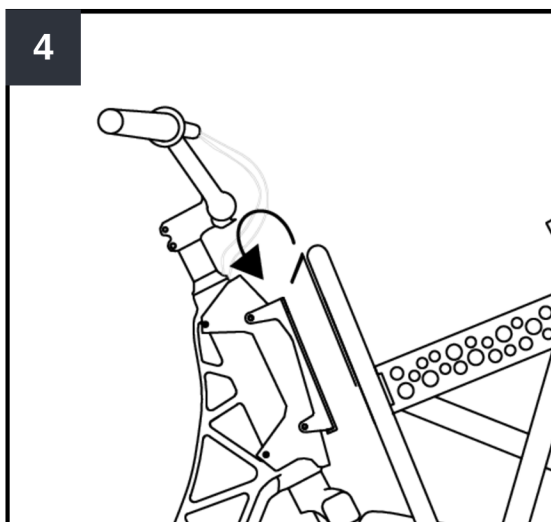
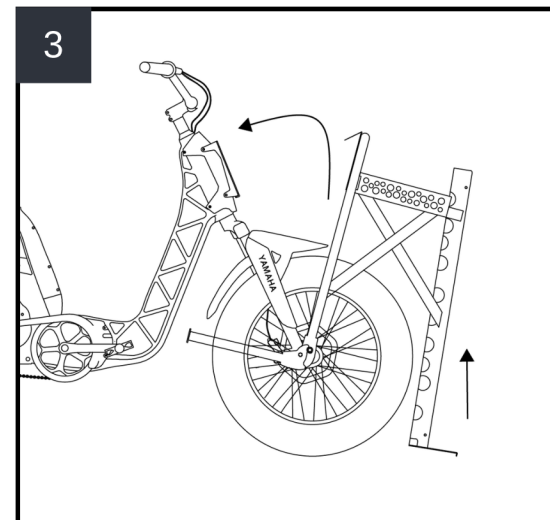
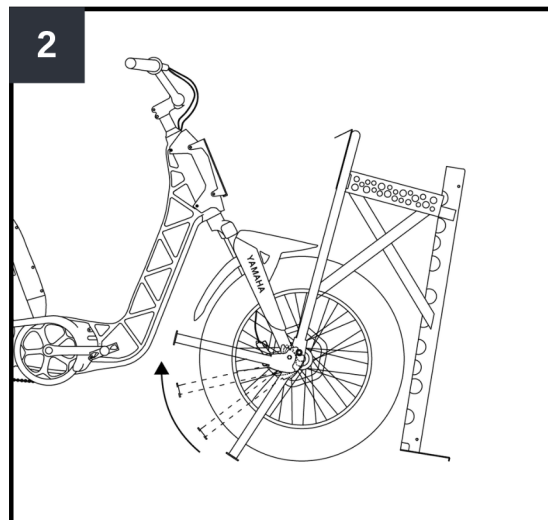
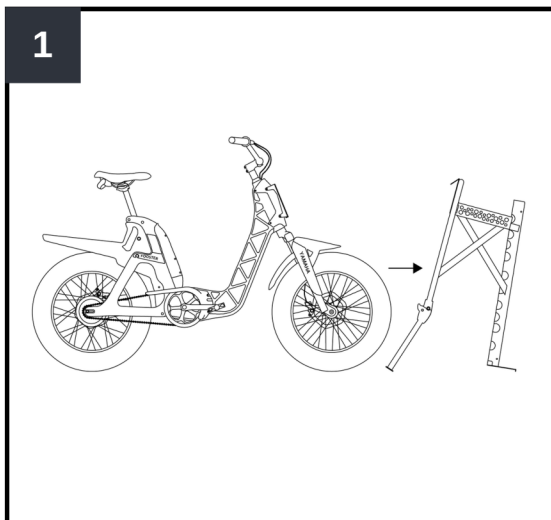

Use of FATBAGRACK GENERAL

15 Maximum speed 15km/h



Do not sit on the bicycle when using a bike stand to avoid dents on a fairway.



Check and tighten fasteners regularly



The maximum load on the rack 10 kg.
The maximum load must not be exceeded



Always keep straps closed and tight.
Make sure there are not hanging or loose straps.

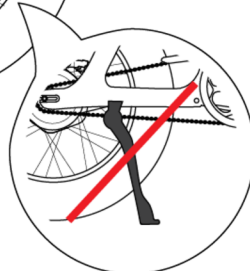
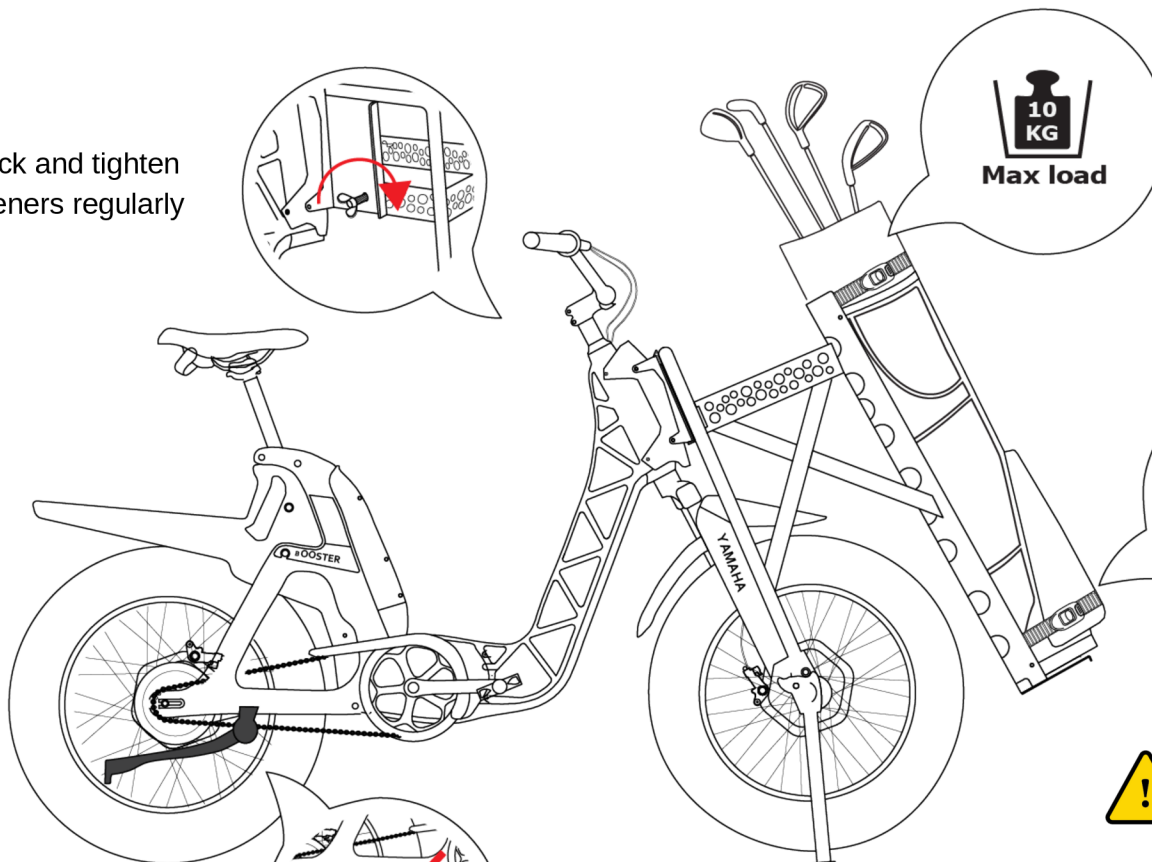

Do not use the kickstand of the bicycle when using Fatbagrack. With the kickstand the Fatbagbike might be unstable and fall over.



Use of FATBAGRACK

PARKING

1

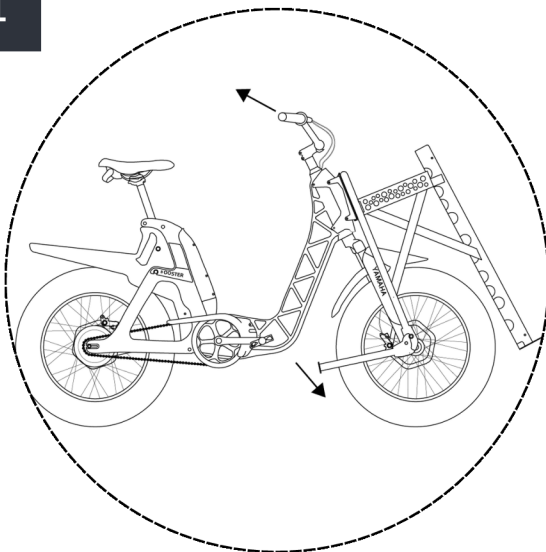

Park Fatbagbike by using the bike stand of Fatbagrack. Lower the bike stand with your foot and simultaneously pull the handles toward your shoulder until the stand locks into place

2

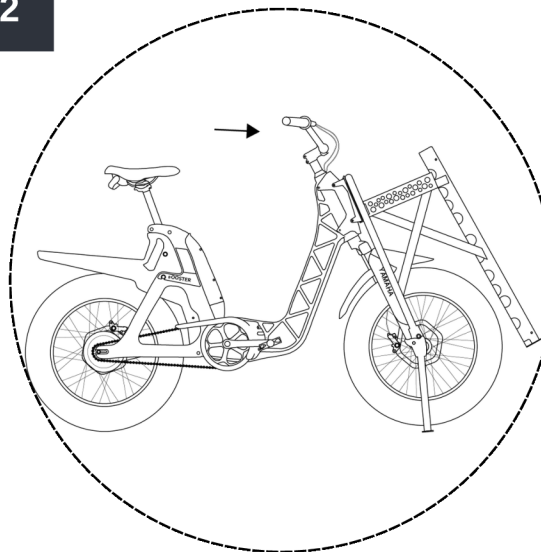

Release the bike stand by pushing the handles forward.



Long-term storage

FATBAGRACK. For long-term storage, remove Fatbagrack from the bicycle and keep the bike stand in the upright position.

Store Fatbagrack in flat/stable and dry place.

FATBAGBIKE. Store the bicycle according to the bicycle manufacturer's instructions.

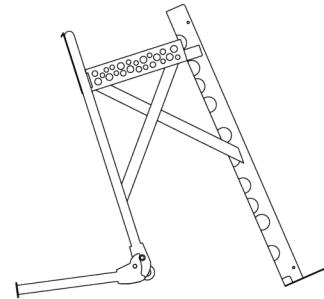

Maintenance

FATBAGRACK. Check regularly all fasteners and visible damage on the Fatbagrack. Slightest sign of deviation shall be corrected immediately.

WARNING! Damaged components may have sharp edges that could cause injury.

Clean the Fatbagrack on a regular basis to extend its service life.

Oil the bike stand joints regularly.

FATBAGBIKE. Maintain the bicycle according to the bicycle manufacturer's instructions.

Recycling

PACKAGING. The outer packaging protects the Fatbagrack during transport. The packaging materials, plastic and cardboards are recyclable.

FATBAGRACK. When disposing of Fatbagrack, check the recyclability of each item. Fatbagrack is mostly made of steel.

FATBAGBIKE. When the bicycle has reached the end of its use, dispose of it according to bicycle manufacture's instructions.

For more information about recycling, contact your local waste management facility or visit related sites on the internet.





Rahtitie 2
27510 Eura
Finland

www.fatbagbike.com

Copyright © 2024
Fatbagbike.
All rights reserved.
Pat.pend. 466221WO-H